

Buffalo Choppers / Bowl Cutter Food Processors

ITEM: 47834
MODEL: FP-ES-0055

47835
FP-ES-0095

47836
FP-ES-0135



Bowl cutting produces as much as 15% higher finished product yield.

These bowl cutters have numerous features that demonstrate its wide possibilities of use, both universal cutter and emulsifier, to produce fine and delicate pastes.

You can chop and knead (kneading in two senses) to perfection any type of charcuterie (sausages, pates, etc.), vegetarian cuisine (onions, potatoes, carrots, lettuce, etc.), poultry, fish, processed cheeses, pastries, and many commodities of the food processing industry.

The presentation of the product is optimal, since the meat mix is not crushed, bruised or drained.

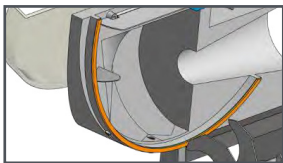

Removable lid/bowl friction band and bowl rim scraper

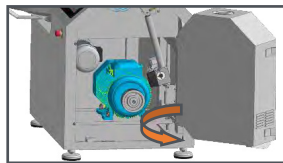

Large openings and folding electric distribution panel

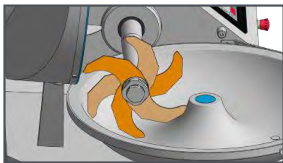

Knife head assembly: 6 or 3 knives



Digital control 15" touch screen

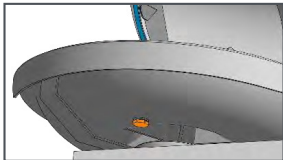

Bowl drain plug

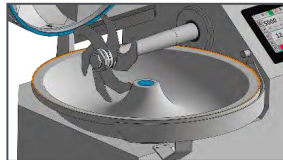

Elevated outer bowl rim

FEATURES:

- Solid cast stainless steel bowl with a liquid drain cast
- Front guard protects spilling of liquids/dough
- Highly productive while efficient on power
- Fast cutting speeds and large bowl capacity
- High Productivity and Efficient Power
- Easy cleaning and maintenance
- Thermal protection on all motors
- Large openings to access the interior

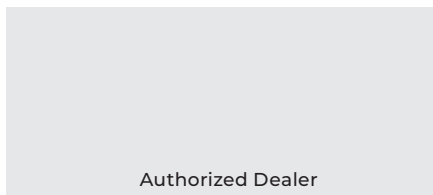

Authorized Dealer



*Power cord and plug not included; must be installed by a certified electrician



Technical Specification			
Features	58 Qt. (55 L) Bowl Volume	100 Qt. (95 L) Bowl Volume	143 Qt. (135 L) Bowl Volume
Item	47834	47835	47836
Model	FP-ES-0055	FP-ES-0095	FP-ES-0135
Bowl Volume	58 Qt. (55 L)	100 Qt. (95 L)	143 Qt. (135 L)
Mixture Bowl Capacity Approx.	88 lb. (40 kg.)	110 lb. (50 kg.)	155 lb. (70 kg.)
Machine Power	16.5 kW / 22.5 hp	25 kW / 34 hp	35 kW / 48 hp
Knife Motor Power	15 kW / 20.5 hp	22 kW / 30 hp	30 kW / 41 hp
Knife Speed (Variable)	500 - 5000 RPM		
Bowl Speed	4 - 20 RPM		
Electrical	220V / 60Hz / 3Ph		
Amps	-	100 A	125 A
Net Weight	1984 lb. (900 kg.)	3087 lb. (1400 kg.)	4409 lb. (2000 kg.)
Net Dimensions (WDH)	61.5" x 47" x 65.5" (1562 x 1194 x 1664 mm)	66" x 63" x 72" (1680 x 1420 x 1820 mm)	100" x 68" x 79" (2540 x 1730 x 2000 mm)
Gross Weight	2205 lb. (1000 kg.)	3307 lb. (1500 kg.)	4623 lb. (2097 kg.)
Gross Dimensions (WDH)	56" x 55" x 66" (1420 x 1390 x 1680 mm)	85" x 71" x 73" (2150 x 1800 x 1600 mm)	
Plug Type	Bare Wire		

TECHNICAL DRAWINGS

